

TECNOSEAL FOUNDRY s.r.l
Via Senese, 193
58100 Grosseto
ITALY
www.tecnoseal.it

Headquarters
Tel. +39 0564 453792

Commerciale Italia
Tel. +39 0564 465483
nautica.italia@tecnoseal.it

Export department
Tel. +39 0564 453917
sales@tecnoseal.com

TECNOSEAL MARINE ANODES USA
2070 NW29th St. - Oakland Park
Fort Lauderdale, FL 33311 - USA
Tel: +1 (954) 874.6309
info@tecnoseal-usa.com
www.tecnoseal-usa.com

TECNOSEAL UK LTD
Unit 5, Crosshouse Centre
The Crosshouse Road
Southampton - SO14 5GZ - UK
Tel: +44 (0) 2380 338941
sales@tecnoseal.co.uk
www.tecnoseal.co.uk

TECNOSEAL NL B.V.
Moerbeij 2b
3371 NZ
Hardinxveld-Giessendam
NETHERLANDS
Tel. +31 (0) 85 486 1999
sales@tecnoseal.nl
www.tecnoseal.nl

00939AL

BRP (Omc / Johnson -Evinrude) - Serie Omc anodes and kit anodes / Anodi e kit anodi Omc

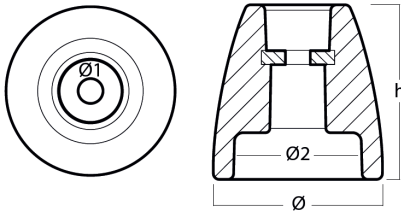

AL Aluminium Brand: BRP (Omc / Johnson
-Evinrude)

Evinrude prop anode

Product technical specification

COD	kg	lbs		h	Ø	Ø1	Ø2
00939AL	0.24	0.53	mm	60	58	8.50	44
			inch	2.36	2.28	0.33	1.73

Main features

Catalog page:

Where it is installed: Johnson-Evinrude E-TEC G2 200/300 HP

Original code: 5009220

Sold in the kit: KIT ETEC G2

Other information

Barcode: 8033837069621

Boat type: motorboat with outboard

Specific: outboard